

The Landmark

LONDON



THE LEADING HOTELS
OF THE WORLD®



Hotel Location



An oasis of luxury in Central London



Grand Ballroom

504 Lunch/Dinner | 266 Classroom | 264 Cabaret



Grand Ballroom

Cabaret style



Ballroom

408 Lunch/Dinner | 176 Classroom | 160 Cabaret



Drawing Room

300 Drinks Reception | 180 Lunch/Dinner | 200 Theatre



Empire Room

220 Theatre



Tower Suite

25 Boardroom



Landmark Rooms

16 Boardroom



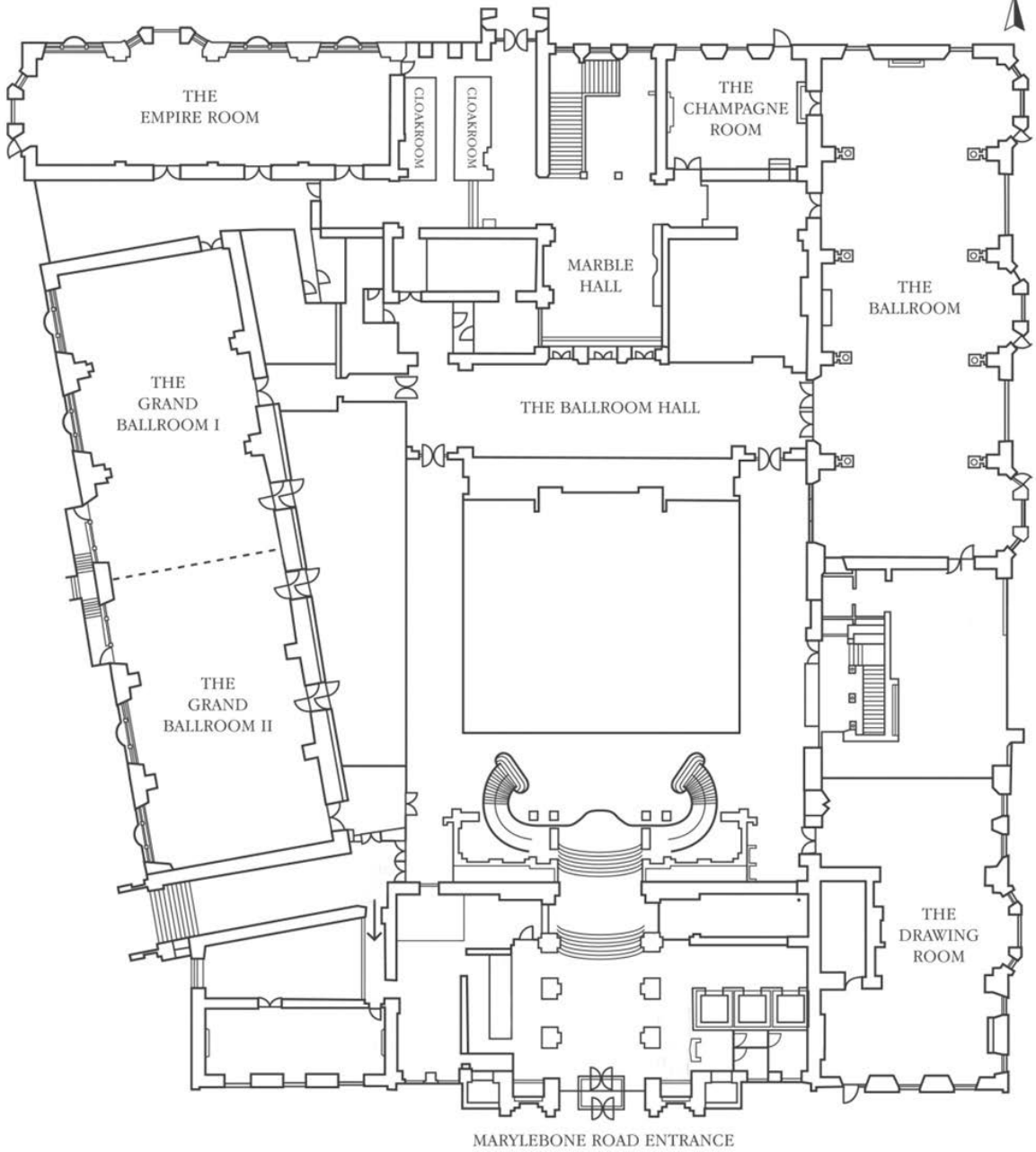

Floor Plan



Superior and Deluxe Rooms

From 35 square metres | 376 square feet



Executive Room

Approx. 52 square metres | 560 square feet



Executive Twin Room

Approx. 52 square metres | 560 square feet



Luxurious Suites

From 60 square metres | 646 square feet



Dining at The Landmark London



Luxurious Spa & Health Club





The Landmark London
222 Marylebone Road | London NW1 6JQ
www.landmarklondon.co.uk | +44 (0) 20 7631 8000